



FLOOR PLAN A

FIRST FLOOR



ROOF TERRACE



GARDEN



GROUND FLOOR

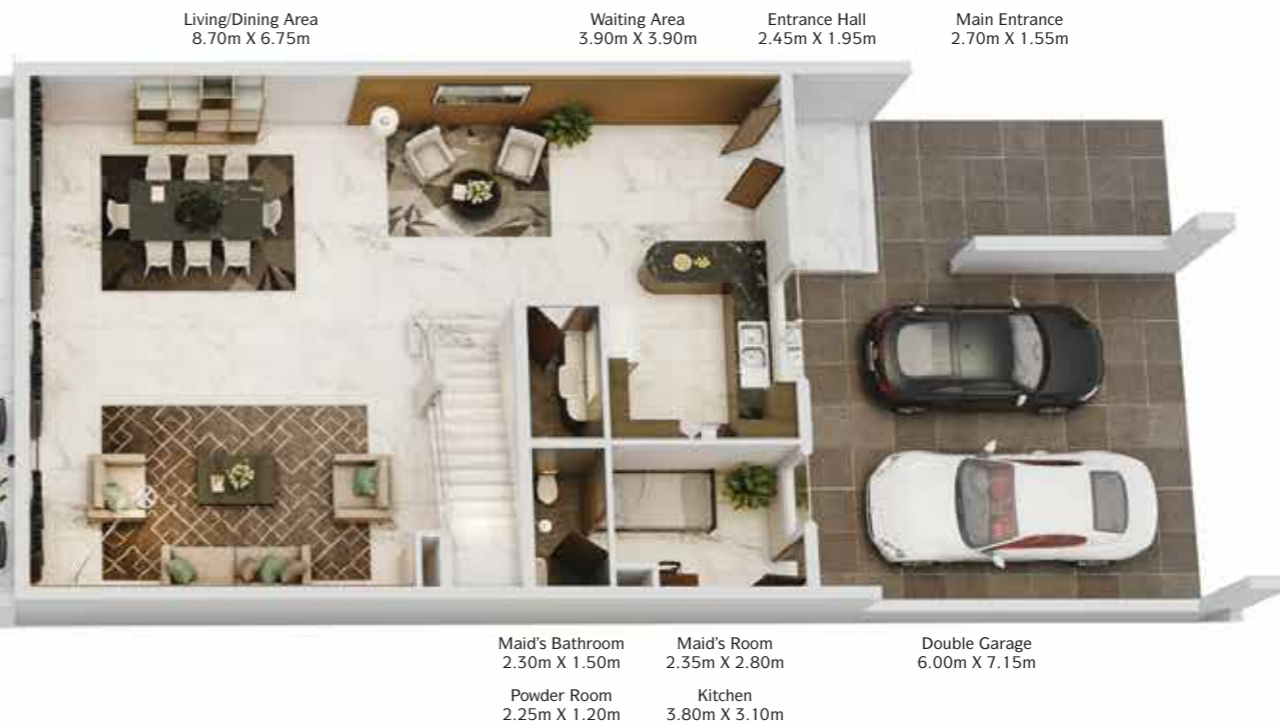

Jumeirah Park Homes 4-Bedroom Residences

Built Up Area (Sq.ft.)	Balcony & Terrace (Sq.ft.)	Gross Floor Area (Sq.ft.)
3,461.16	375.66	3,836.83

The developer reserves the right to make revisions. All the measurements and drawings are approximate. All information is subject to change without notice. Do not scale drawings. Artistic renderings, landscaping and images are for illustrative purposes only and are subject to change without notice. November 2018.



FLOOR PLAN B



FIRST FLOOR



ROOF TERRACE



GARDEN



GROUND FLOOR

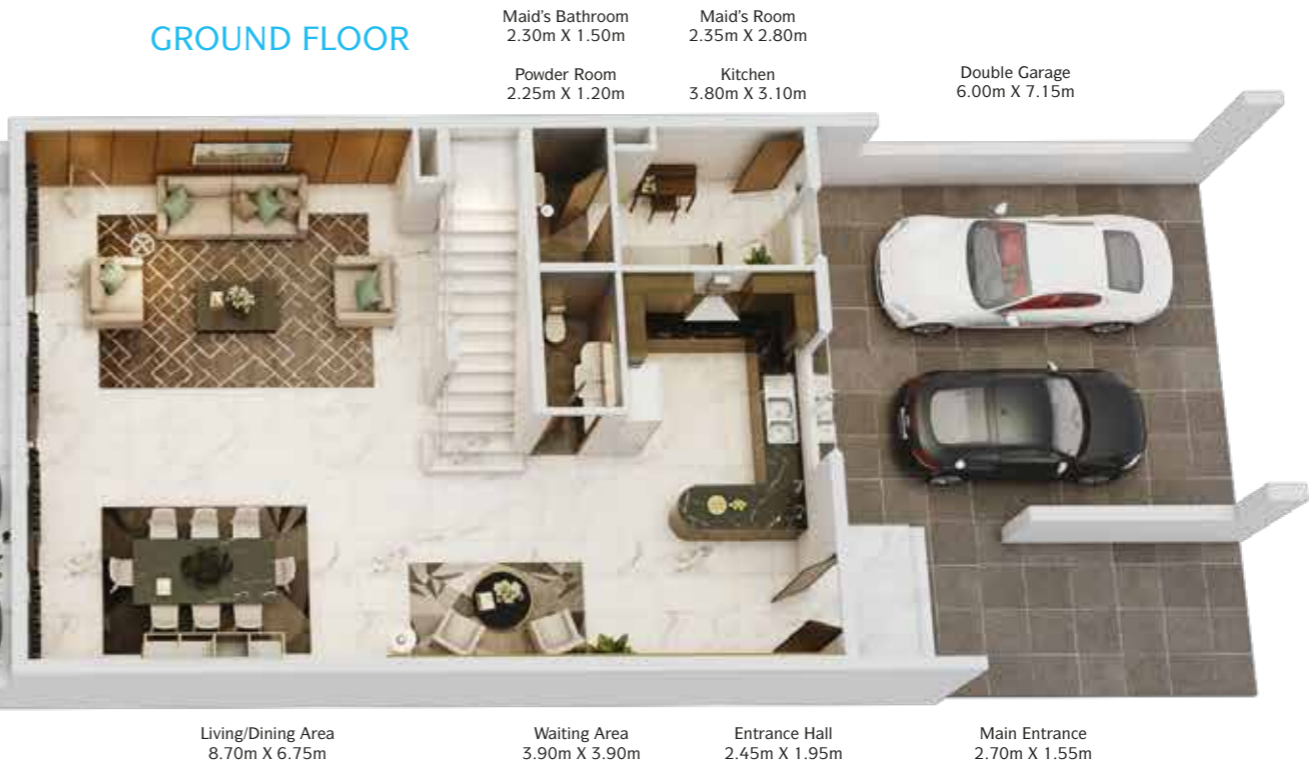

Jumeirah Park Homes 4-Bedroom Residences

Built Up Area (Sq.ft.)	Balcony & Terrace (Sq.ft.)	Gross Floor Area (Sq.ft.)
3,461.16	375.66	3,836.83

The developer reserves the right to make revisions. All the measurements and drawings are approximate. All information is subject to change without notice. Do not scale drawings. Artistic renderings, landscaping and images are for illustrative purposes only and are subject to change without notice. November 2018.

